

# Neat-F

 free standing luminaire

Modern and simple design style, coupled with exquisite materials and perfect assembly details, the product appearance looks rich in texture. Integrated die-cast 22mm ultra-thin lamp head, The direct light adopts a diffusion plate with microprism structure to realize anti-glare function, and 80 degrees (direct), 115 degrees (indirect). This product is DIY assembled, no need professionals, portable on one side of the desktop, easy to install, flexible for using. Typical value is 125LM/W, flicker free, KNOB dimming, 50% DIRECT / 50% INDIRECT synchronous dimming control, The main materials are aluminum profiles, steel and PMMA. With cuttable pole. The item is especially designed for WHOLESALER sales channels.

## Features

---

Simple and exquisite industrial design with rich texture

---

High lumen efficiency reach to 125LM/W, fitting with a 3300lm direct and 4200lm indirect lights, total 7500lm lumen output

---

Integrated die-cast 22mm ultra-thin lamp head

---

UGR<19, lighting uniform and healthy

---

Integrated packaging, easy for transportation and online sales

---

Knob dimming

---

5 years warranty

---

## Application Areas

---

Open-plan office, individual office, etc.

---



## Technical data

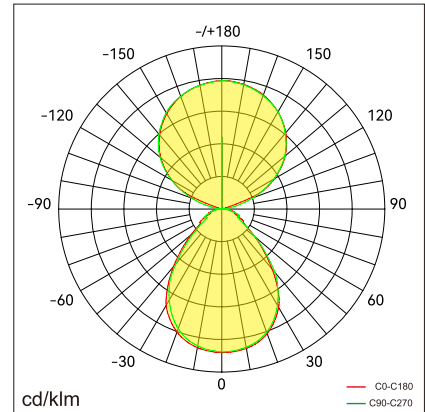
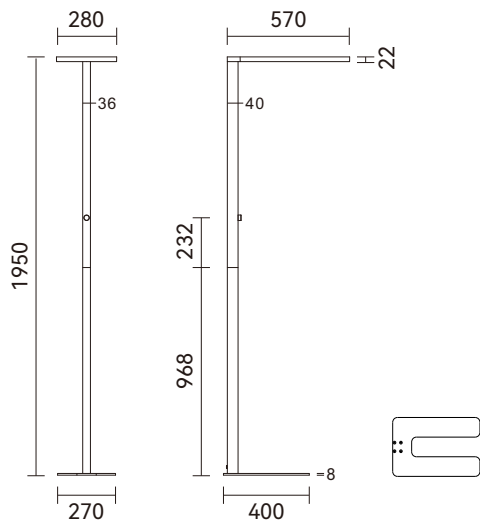

Item No.	BNEJ-1906030-BN
Input Power(±10%)	↑ 30W/30W ↓
Input Voltage	AC200~240V
Power Factor	≥0.9
Luminous Flux(±10%)	↑ 4200lm/3300lm ↓
UGR	<19
Color Rendering Index	>80
Life Time	L80(B10)50,000H
Beam Angle	↑ 115°/80° ↓
CCT(±200K)	3000/4000/6000K
Colour consistency SDCM	< 5
Dimming	Knob dimming
Sensor	No
Housing Color	Silver / White / Black
Fixture Materia	6063AL
Protection Level	IP20
Storage Temperature	-40°C~+80°C
Working Temperature	-20°C~+45°C
Net Weight	10.2kg
Gross Weight	12.8kg
Package size	1105*453*118mm (1pcs)
40GP	504pcs
20GP	1040pcs

# Packaging

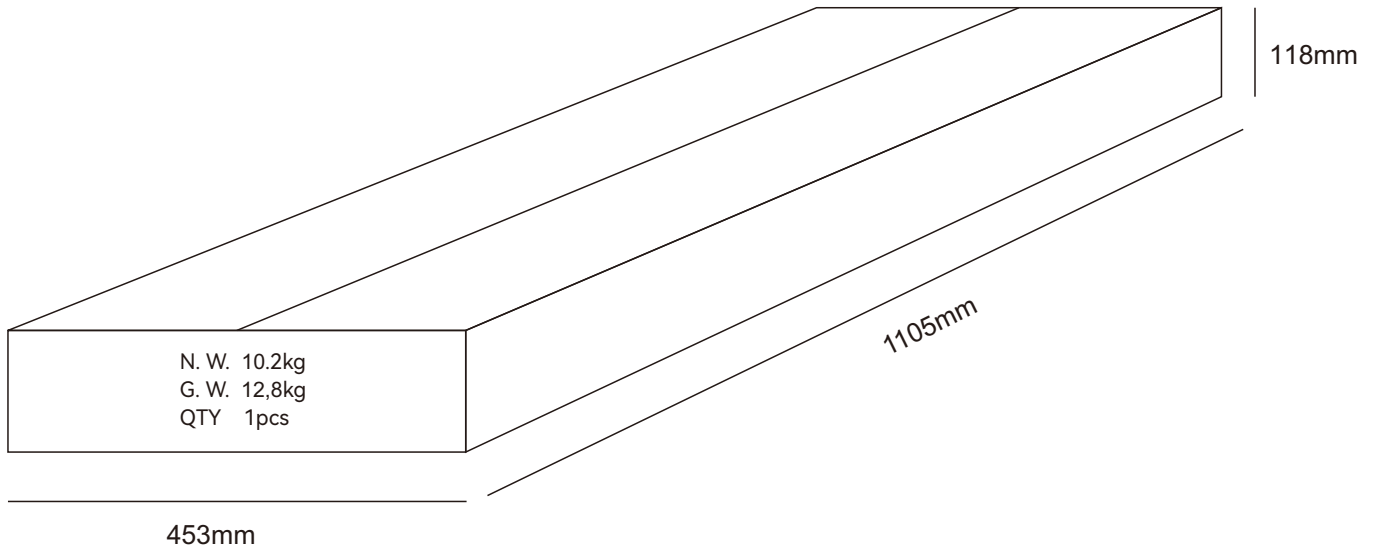

Shenzhen Nexol Lighting Technology Co.,Ltd.

E-mail: [info@nexol-lighting.com](mailto:info@nexol-lighting.com)

[www.nexol-lighting.com](http://www.nexol-lighting.com)

Factory: Floor 6-9, Building 3, Tonghu Intelligent Industrial Park, Zhongkai High-Tech District, HuiZhou 516035

Office: Room 306&309, Floor 3, Building E, Longhua Digital Industrial Park, Guanlan Road 54-6, Longhua district, Shenzhen, China 518110



All values in specification are typical value from laboratory measurement, for concrete data, please refer to shipment testing report. Information provided is subject to change without notice. Please verify all details with NEXOL Lighting.

Copyright Shenzhen Nexol Lighting Co., Ltd.. All rights reserved.