



NATURE T is a portable rechargeable desk lamp with a compact and exquisite design that can last for 8 hours at full power.

It is controlled by the touch button on the top of the lamp to switch on and switch off the lamp and adjust its brightness.

NATURE T's excellent optical design with a wide range of irradiation, IP65/IK08, meets various indoor and outdoor lighting needs

Features

At full power can be used for 8 hours

145° Wide beamangle, Providing broad illumination

Charge with a data cable

Battery is replaceable

Lamp head is detachable

Easy for storage

Lamp protection grade IP65/IK08



Application Areas

Ideal for domestic environments – from the living room to the garden – and for the world of catering,

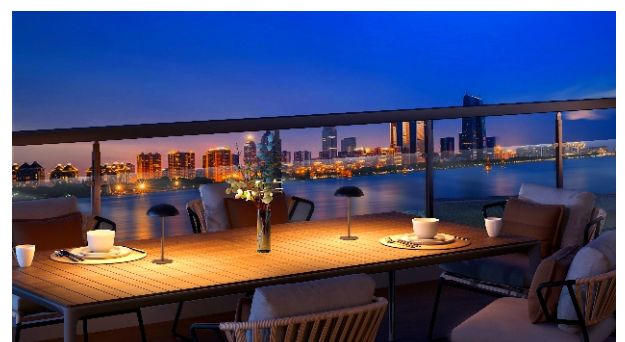

Technical data

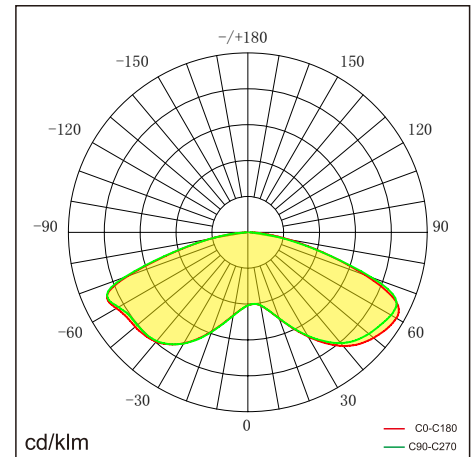
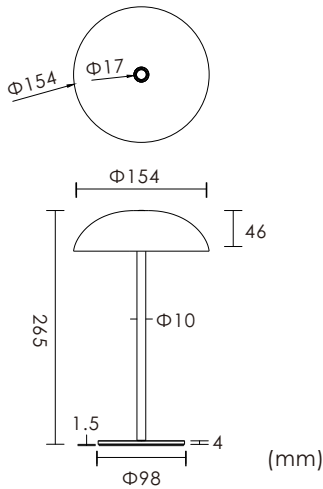

Item No.	B9NT0-04280-TN	B9NT0-04380-TN	B9NT0-04580-TN
Input Power	4W		
Output	DC 5V/2A		
Batteria	double-cell lithium battery pack (21700 lithium battery 3.7V 10000mAh)		
Battery Run time	In maximum power and constant brightness, usable time is 8 h (± 1 h)		
Charge time	8 h (± 1 h)		
Power Factor	≥ 0.9		
Luminous Flux($\pm 5\%$)	344 lm (2700K)		
Colour temperature	2700K	3000K	4000K
Color Rendering Index	> 90		
Life Time	L70(B50)50,000H		
Beam Angle	145°		
Colour consistency SDCM	< 3		
Dimming	Touch dimming		
Sensor	NO		
Housing Color	Silver / White / Black / Dark Grey / Madeira brown / Blackberry leaf green / Hermosa pink / Spruce blue		
Fixture Materia	ADC12+Q235+PC		
Protection Level	IP65/IK08		
Storage Temperature	$-30^{\circ}\text{C} \sim +60^{\circ}\text{C}$		
Working Temperature	$-30^{\circ}\text{C} \sim +45^{\circ}\text{C}$		
Net Weight	0.87kg		
Package size	inner box 260*222*75mm (1PCS) / master carton 555*455*280mm (12PCS)		
20GP	416 PCS (master carton)		
40GP	972 PCS (master carton)		



Type-C charger

Shenzhen Nexol Lighting Technology Co.,Ltd.

E-mail: info@nexol-lighting.com

www.nexol-lighting.com

Factory: Floor 6-9, Building 3, Tonghu Intelligent Industrial Park, Zhongkai High-Tech District, HuiZhou 516035

Office: Room 306&309, Floor 3, Building E, Longhua Digital Industrial Park, Guanlan Road 54-6, Longhua district, Shenzhen, China 518110

All values in specification are typical value from laboratory measurement, for concrete data, please refer to shipment testing report.
Information provided is subject to change without notice. Please verify all details with NEXOL Lighting.

Copyright Shenzhen Nexol Lighting Co., Ltd.. All rights reserved.